

## BlackGuard PVC Coated Junction Boxes for Hazardous Locations - GUAC

BlackGuard PVC coated GUA style fittings are available in a variety of shapes and dimensions. GUA style boxes are used in hazardous locations. All GUA style boxes are supplied PVC Coated with PVC Coated covers and a seal between the coating of the boxes and the coating of the covers.

### Features

- Exterior dark grey PVC coating with a minimum thickness of 40 mil
- Interior Urethane coating with a minimum thickness of 2 mil
- Sizes available are 1/2" through 2"
- Sealing sleeves extender 1 pipe diameter or 2 inches, whichever is greater, beyond all female openings



### Specifications

- National Electrical Code:
  - Class I, Div 1&2, Groups C,D
  - Class II, Div 1, Groups E,F,G
  - Class II, Div 2, Groups F,G
  - Class III • UL Standard 886
- ANSI Standard C-33.27
- CSA Standard: C22.2 No. 30
- NEMA/EEMAC 3, 4

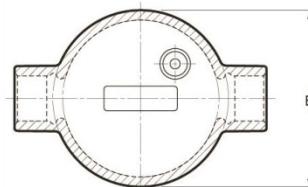
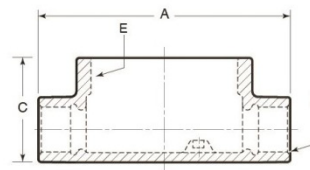

PART NUMBER	SIZE	Cover Opening	A	B	C	D	WEIGHT PER 100	ALUMINUM PART NUMBER
PVC-FIT-GUAC05014	1/2"	2"	2.58	2.29	2.19	0.67	200	
PVC-FIT-GUAC05016	1/2"	3"	3.58	2.04	1.88	0.67	210	PVC-FIT-GUAC05016A
PVC-FIT-GUAC07524	3/4"	2"	2.58	2.04	2.00	0.79	250	
PVC-FIT-GUAC07526	3/4"	3"	3.58	2.04	1.88	0.79	320	PVC-FIT-GUAC07526A
PVC-FIT-GUAC10036	1"	3"	3.58	2.35	2.19	0.92	370	PVC-FIT-GUAC10036A
PVC-FIT-GUAC12547	1-1/4"	3-5/8"	4.33	2.73	2.75	1.13	520	PVC-FIT-GUAC12547A
PVC-FIT-GUAC12549	1-1/4"	5"	5.83	3.85	3.75	1.20	850	
PVC-FIT-GUAC15059	1-1/2"	5"	5.83	3.85	3.75	1.32	1120	PVC-FIT-GUAC15059A
PVC-FIT-GUAC20069	2"	5"	5.83	4.10	4.00	1.60	1250	PVC-FIT-GUAC20069A